

Nutriflex® Omega Peri Novo

Emulsion for Infusion

0739/12631289/1124

2500 ml

MFG DATE
Lot:
EXP

1910 kcal
Amino acid 80 g
Lipid 100 g
Carbohydrate 160 g



Excipients:
Citric acid monohydrate (for pH adjustment)
Glycerol
Egg phospholipids for injection
Sodium oleate
Sodium hydroxide (for pH adjustment)
all-rac-alpha-Tocopherol
Water for injections

Amino acid content: 80 g
Nitrogen content: 11.4 g
Carbohydrate content: 160 g
Lipid content: 100 g

Electrolytes:
Sodium 100 mmol
Potassium 60 mmol
Magnesium 6.0 mmol
Calcium 6.0 mmol
Zinc 0.06 mmol
Chloride 96 mmol
Acetate 80 mmol
Phosphate 15.0 mmol

Energy in the form of lipids 3980 kJ (950 kcal)
Energy in the form of carbohydrates 2680 kJ (640 kcal)
Energy in the form of amino acids 1340 kJ (320 kcal)
Non-protein energy 6660 kJ (1590 kcal)
Total energy 8000 kJ (1910 kcal)

Osmolality
Theoretical 950 mOsm/kg
osmolality 840 mOsm/l
pH 5.0 – 6.0

01/2613272/0417

peripheral
or central
venous

MCT/LCT



with
Electro-
lytes

2000 mL

2500 ml of the ready-for-use emulsion contain after mixing of the three chamber contents from this chamber (500 ml):

Medium-chain triglycerides 50.00 g
Soya-bean oil, refined 40.00 g
Omega-3-acid triglycerides 10.00 g

Emulsion for infusion
Intravenous use.

Infusion into a peripheral or central vein.

Read the package leaflet before use. Keep out of the sight and reach of children. Jauhi ubat dari kanak-kanak. High in sodium – see leaflet for further details. Contain egg phospholipid from hens and omega-3-acid-triglycerides from fish. After removing the protective overwrap and after mixing of contents of the bag (Before spiking of the infusion port). Chemical and physicochemical in-use stability of the mixture of amino acids, glucose and fat was demonstrated for 7 days at 2-8 °C and additional 2 days at 25 °C. After admixture of compatible

additives. From a microbiological point of view, the product should be used immediately after admixture of additives. If not used immediately after admixture of additives, in-use storage times and conditions prior to use are the responsibility of the user.

After first opening (spiking of the infusion port). The emulsion is to be used immediately after opening of the container. Do not store above 25 °C. Do not freeze. If accidentally frozen, discard the bag. Keep the bag in the protective overwrap in order to protect from light.

Reg Number: MAL24116027AZ

Controlled Medicine
Ubat terkawal
Prescription Only Medicine

2500 ml of the ready-for-use emulsion contain after mixing of the three chamber contents from this chamber (1000 ml):

Glucose monohydrate 176.0 g
equivalent to glucose 160.0 g
Sodium dihydrogen phosphate dihydrate 2.340 g
Zinc acetate dihydrate 13.20 mg

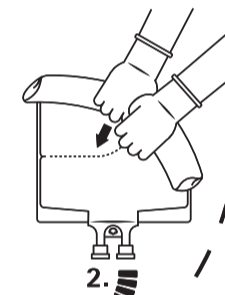
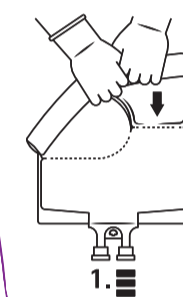

1000 mL

250 mL

2500 ml of the ready-for-use emulsion contain after mixing of the three chamber contents from this chamber (1000 ml):

Isoleucine	4.680 g	Aspartic acid	3.000 g
Leucine	6.260 g	Glutamic acid	7.000 g
Lysine hydrochloride	5.680 g	Glycine	3.300 g
equivalent to lysine	4.546 g	Proline	6.800 g
Methionine	3.920 g	Serine	6.000 g
Phenylalanine	7.020 g	Sodium hydroxide	1.600 g
Threonine	3.640 g	Sodium chloride	2.162 g
Tryptophan	1.140 g	Sodium acetate	
Valine	5.200 g	trihydrate	1.088 g
Arginine	5.400 g	Potassium acetate	5.886 g
Histidine hydrochloride monohydrate	3.380 g	Magnesium acetate tetrahydrate	1.288 g
equivalent to histidine	2.502 g	Calcium chloride dihydrate	0.882 g
Alanine	9.700 g		

B | BRAUN

Product registration holder:
B. Braun Medical Industries Sdn. Bhd.,
Bayan Lepas Free Industrial Zone,
11900 Bayan Lepas, Penang, Malaysia.

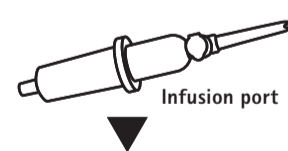

Infusion port

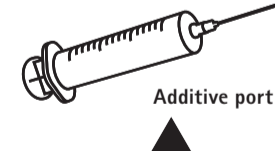

Additive port

Product Owner:
B. Braun Melsungen AG,
Carl-Braun-Straße 1,
34212 Melsungen,
Germany.

Manufactured by:
B. Braun Melsungen AG,
Am Schwerzelschhof 1,
34212 Melsungen,
Germany.

Approval for Printing

B | BRAUN Melsungen AG

Approved for Printing

Approved for Printing when corrected

New draft required

LRA:

Date _____ Signature _____

Name in capital letters

LMS:

Date _____ Signature _____

Name in capital letters

Black

HKS 46 (colour cliche)

Bag outline (no printing color! For information only!)

Dimension (printable area): 250 x 400 mm

LLD-Spec.: M55

Serialized: __

LIFE_N__3CB__MY__0739

Construct: 0739/12631290/1124

BLACK (cliche): 0739/12631289/1124

Colour (cliche): 0/12613272/0417

Product: LIFE N 3-Chamber bag 2500 ml

Production site: LIFE N

Font size: 10,0 pt.

V-0013

File name:

12631290_NutriflexOmegaPeriNovo_LIFEN--3CB-2500mL_MY.indd

Date of last saving:

15.11.2024 - 13:08:19

Example for variable online print with dummy content:

? n.k.

ASPA ATANI 3 BRAUN
TEL 062874700