

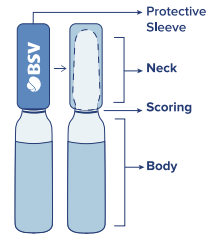

Good Practices for ampoule breakage

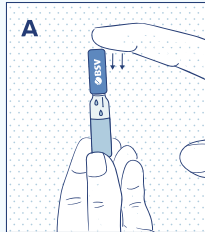

(Fig: Parts of an ampoule)



A
Keep the ampoule vertically straight and tap on the protective sleeve covering the neck slightly as to allow all content (liquid) into the bottom of ampoule.

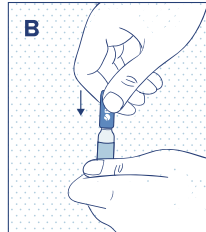

B
Hold the ampoule bottom with one hand firmly. Hold the protective sleeve covering the neck between your thumb and first finger of second hand.

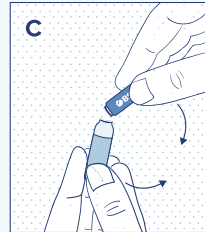

C
Bend the Ampoule slightly and apply the force on the protective sleeve covering the neck away from body gently to break the ampoule.

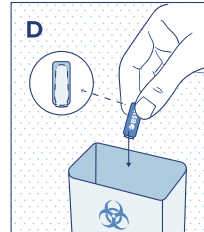

D
Discard the protective sleeve with the top half of the ampoule.

INMA90537E0MY



Artwork Code

INMA90537E0MY

Pack Components		Colours	Other Information/ Symbols	Notes
Product Name	Ampoule Breaking Insert	CMYK	————— Key Line Drawing	Outline and Cutting Marks not to be printed. One Side Printing Zig- zag folds: 5 panel Final Folding Size: L: 32.8 mm H: 57 mm
Strength	----		- - - - - Crease Line	
Contents	----			
Technical Details				
Dimension	164 x 57 mm			
Material	ITC Print Paper			
Quality	40 gsm			
Effect	----			
Lamination	----			
			Accountability	
			Designer	Anjali Sanu
			Updated by	----
			Date	22-04-2024